



## edge

Perfection created from straight lines, edge provides a classic design appearance through material qualities and craftsmanship.

Cubicle doors and pilasters are manufactured **inline** using **44mm** light weight core board (PEFC) faced with a **real wood veneer** (AC lacquer finish) or high pressure laminate. Panel edges are lipped first to all sides with 20mm/10mm hardwood being vertically rebated to form a flush appearance.

Partitions are manufactured using 30mm light weight core board (PEFC) faced with **real wood veneer** or high pressure laminate. Panel edges are lipped first to all sides with 10mm hardwood to encase the core. Doors are hung on high quality **stainless steel** closing hinges set to allow doors to rest **flush** with the pilasters. Pilasters and partition are fixed with machined hardwood blocks at floor, wall and ceiling junctions (Figs 1,2,5). **Easily operated by people with limited dexterity** the stainless steel Indicator bolt also features an external emergency release facility.

Included to each cubicle is a stainless steel buffered coat hook. Doors and pilasters can be raised to provide a **floating appearance** to the cubicle. **edge** cubicles can be supplied to comply with the latest Building Regulations Part M & Disability Discrimination Act (DDA)

**edge** is also available in 25mm chipboard core (PEFC) for partitions, doors and pilasters.

All sides are hardwood lipped first. Doors and pilasters provide a rebated flush finish appearance to simulate the 44mm version to provide a solution where budgets are limited.





# edge

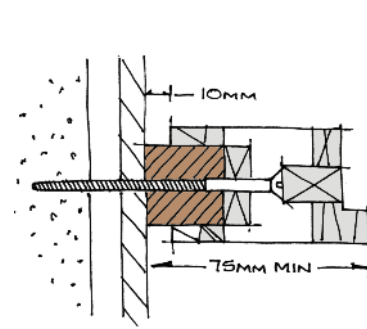

**Pilaster wall fixing (fig 1)**

Pilasters are fixed onto matching hardwood blocks with hidden fixings and matching hardwood pellets.

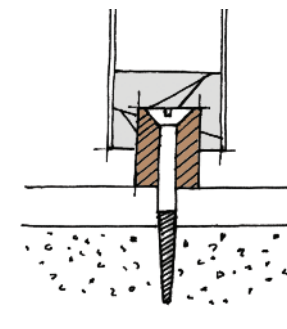

**Division floor fixing (fig 2)**

Divisions are located over matching hardwood blocks which are screwed to the floor. This detail ensures symmetry is maintained with cubicle pilasters.

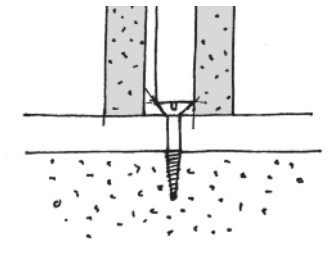

**Division floor fixing to receive tiled skirting (fig 3)**

Divisions are located onto solid phenolic blocks. (Tile, skirting by others)

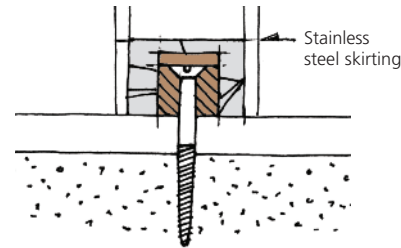

**Division fixing (fig 4)**

Division are located over matching hardwood blocks screwed to the floor. (S/S skirting by others)

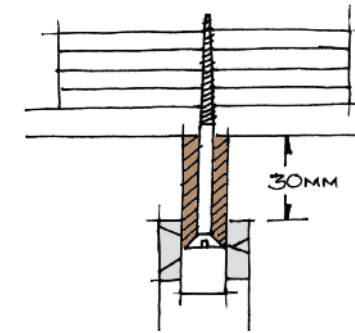

**Pilaster ceiling fixing (fig 5)**

Pilasters are located over matching hardwood blocks which screw to the ceiling.

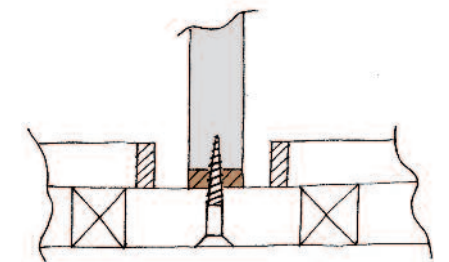

**Division fixing rear duct frame (fig 6)**

Divisions are taken back tight to framework and fixed from behind.

**Floating front (fig 7)**

Divisions cut back to give cubicle front floating appearance.

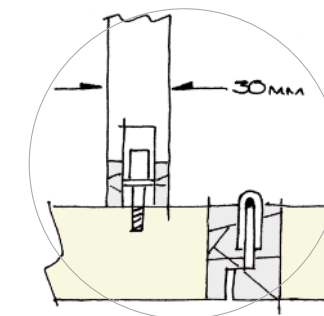
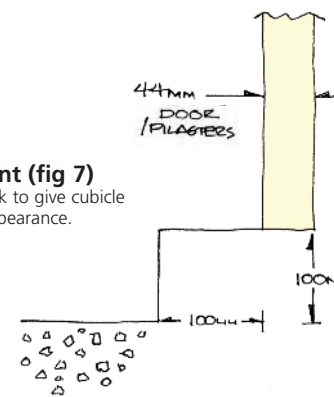

**Pilaster to division (fig 8)**

Pilasters are fixed to the divisions using hidden fixings.

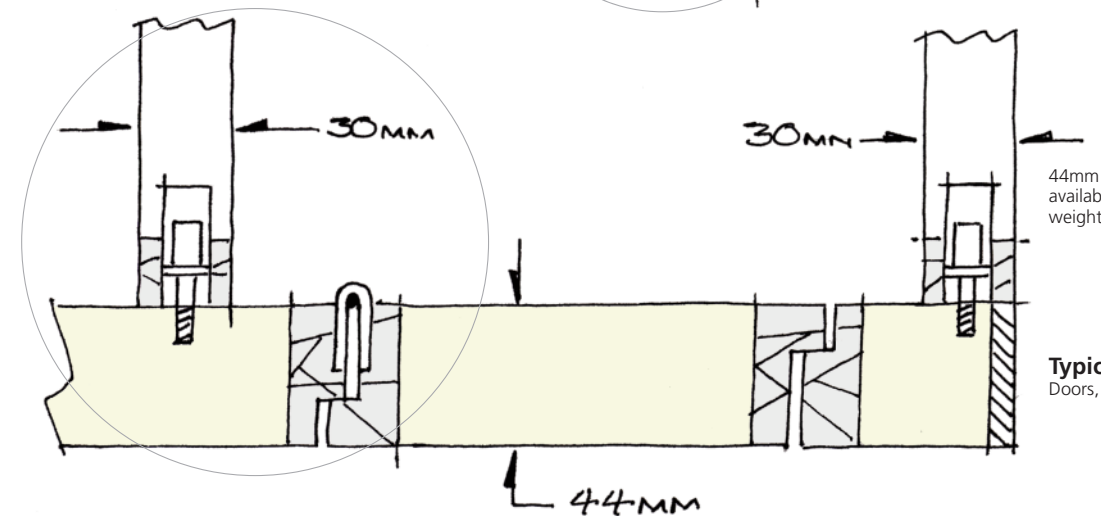

**Typical plan (fig 9)**  
Doors, pilasters, Divisions.

44mm core divisions available subject to size, weight and surcharge

**OPTIONS**

edge is available in 20mm/13mm solid grade laminate options providing a durable rebated flush finished cubicle.

## Toilet Cubicles Ireland

Unit 15,  
Donore Business Park,  
Donore Road,  
Drogheda,  
Co. Louth,  
Ireland

Email: [info@toiletcubiclesireland.ie](mailto:info@toiletcubiclesireland.ie)  
Telephone: 041-9818148  
Mobile: 086-4115757

<http://www.toiletcubiclesireland.ie>